

How to charge (set up) the Thetford Porta Potti 365

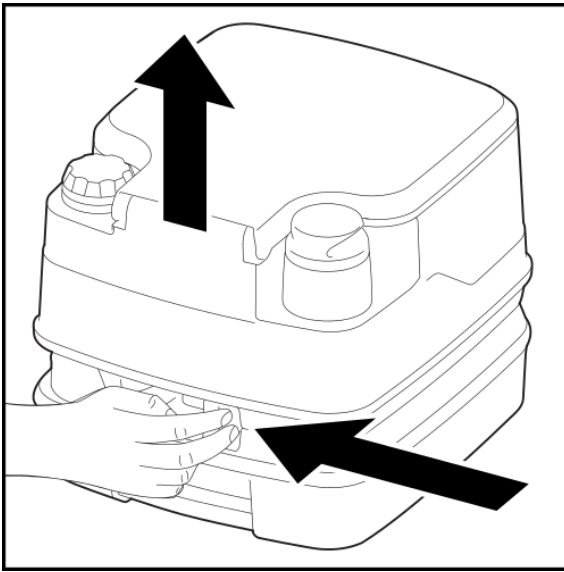

- The Porta Potti is made up of two tanks; the waste-holding tank at the bottom, and the flush-water tank at the top.
- The tanks separate by sliding the catch at the back of the toilet and lifting the top from the bottom.

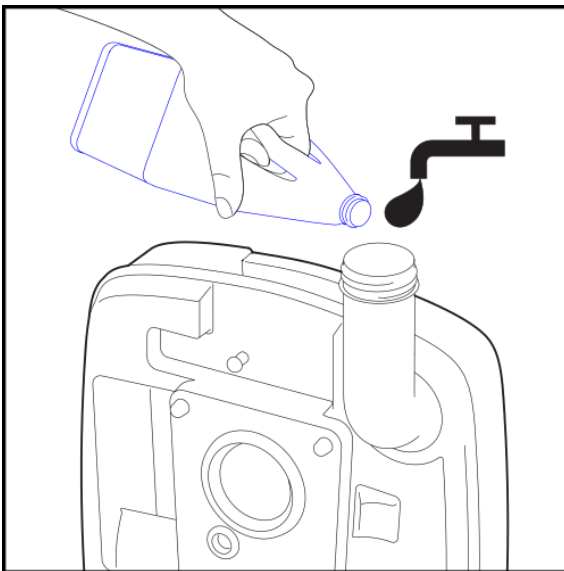

- Once separate, swivel the spout around as per the picture, and remove the screw cap.
- Pour in the correct amount of blue/green toilet chemical and water, replace the screw cap and swivel the spout back into place.
- Reconnect the two tanks of the toilet.

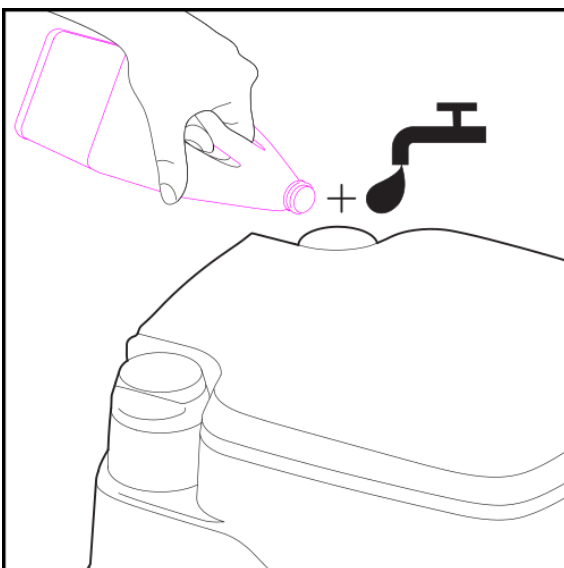

- Now remove the water filler cap on the right hand side back of the toilet.
- Add the recommended dosage of pink flush chemical and fill with water.
- Replace the cap, and put the toilet in place ready for use.

How to discharge (empty) the Thetford Porta Potti 365

- The Porta Potti has a red/green indicator on the front showing when the waste-tank is full (you do not need to wait for the waste-tank to be full, and most campers would empty more routinely).
- To discharge the toilet, firstly ensure that the blade is closed (handle on the front of the toilet is in).
- Separate the two tanks, and take the waste-tank outside.

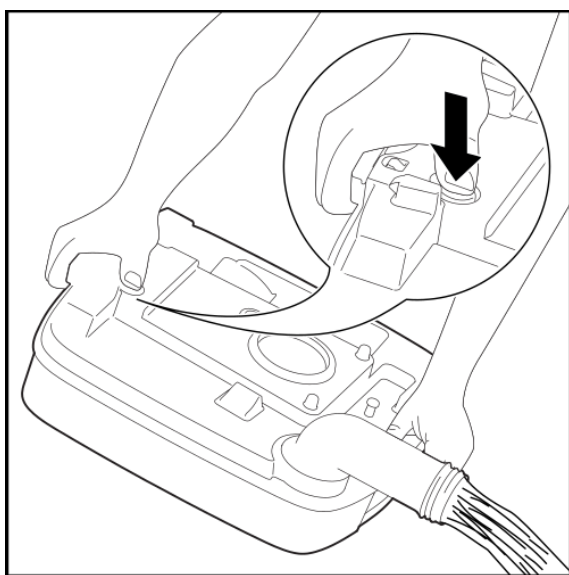
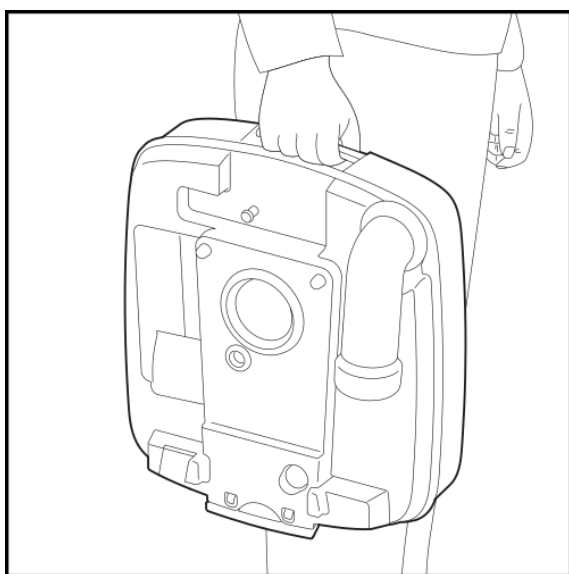

- Carry the toilet as shown in the picture, down to the lat-pit, along with a full watering can.
- When collecting water for toilet use, please do not use the drinking water tap, but use the one attached to the outside of the toilet hut.
- Whilst still holding the waste-tank in an upright position, swivel the spout upwards.
- Remove the screw cap, and empty the contents of the waste-tank into the lat-pit. At the same time press the button at the opposite end of the tank, to allow air in and ease emptying the toilet.
- Pour water from the watering can into the waste tank, gently swirl the water and empty into the lat-pit.
- Repeat until the water coming out is clean.
- When cleaning the lid/seat/ outside of the toilet, you must not use bleach or disinfectant. It is recommended that you use dilute pink fluid (as used in the flush).